

Swimming Pool, Hot Tub & Spa Fact Sheet



Swimming pool definition: Any structure intended for swimming or recreational bathing that is capable of containing water over 24 inches deep. This includes in-ground, aboveground, on-ground swimming pools, hot tubs and spas.

Permits required:

1. Building/Zoning permit, for inspection of required setbacks and placement of the pool and pool deck (if applicable).
 - a. Submit completed Building Permit Application
 - b. Submit a Plot Plan (see sample)
 - c. Pool deck plans (if applicable)
2. Electrical Permit for inspection of "bonding" of the (metallic) pool and proper outlet for the pump/filter.
 - a. Submit completed Electrical Permit Application
 - b. See the back of this sheet for basic bonding/electric info.
 - c. Review code or Electric Permit Manual, at office for more info.

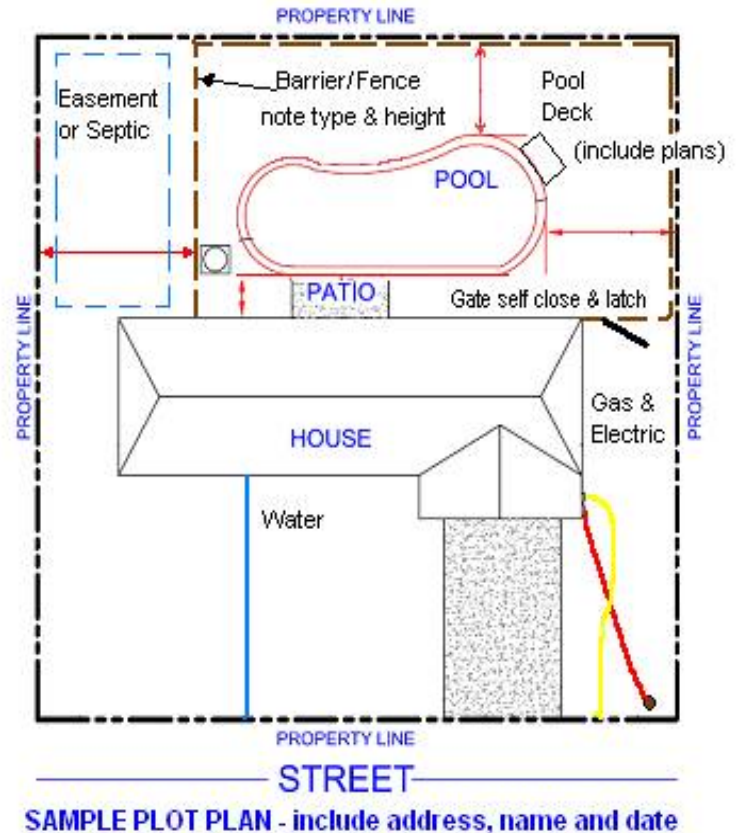

Basic Zoning Requirements:

(See Zoning Ordinance for all requirements)

1. Installation shall comply with all requirements of the Zoning Ordinance.
 - a. Normally, pools shall be located in rear or side yards
 - b. Pools shall maintain the setback required for buildings, from the property line (Normally 10 feet or more).
 - c. Pools shall not be located in easements, under power lines or over septic systems.
 - d. Pools shall be located a minimum of 4 feet from structures.

Basic Code Requirements: (see Building Code Appendix G for all requirements)

2. Installation shall comply with all requirements of the Michigan Building Code.
 - a. A barrier, at least 48 inches tall, shall be provided around area of the pool.
 - b. Pool wall may serve as barrier if it measures at least 48 inches tall and the walls are rigid. Inflated and soft side pools shall require a separate barrier be installed around the pool if walls are not 48 inches tall.
 - c. All openings in barrier shall not allow passage of a 4-inch diameter sphere.
 - d. Access to pool (gates) shall be a minimum of 48 inches tall, open outward and shall be self-closing and self-latching.
 - e. Where a wall of the dwelling serves as part of the barrier additional requirements shall apply. (See Building Official)
 - f. Spas or Hot Tubs with a safety cover which complies with ASTM F 1346 are exempt from barrier requirements.

The information on this sheet only includes basic requirements; consult original documents for specific requirements. **See back of this sheet for electrical requirements.**

Electrical Information for Swimming Pool, Hot Tub or Spa

PAGE 1 FOR PERMANENTLY INSTALLED POOLS

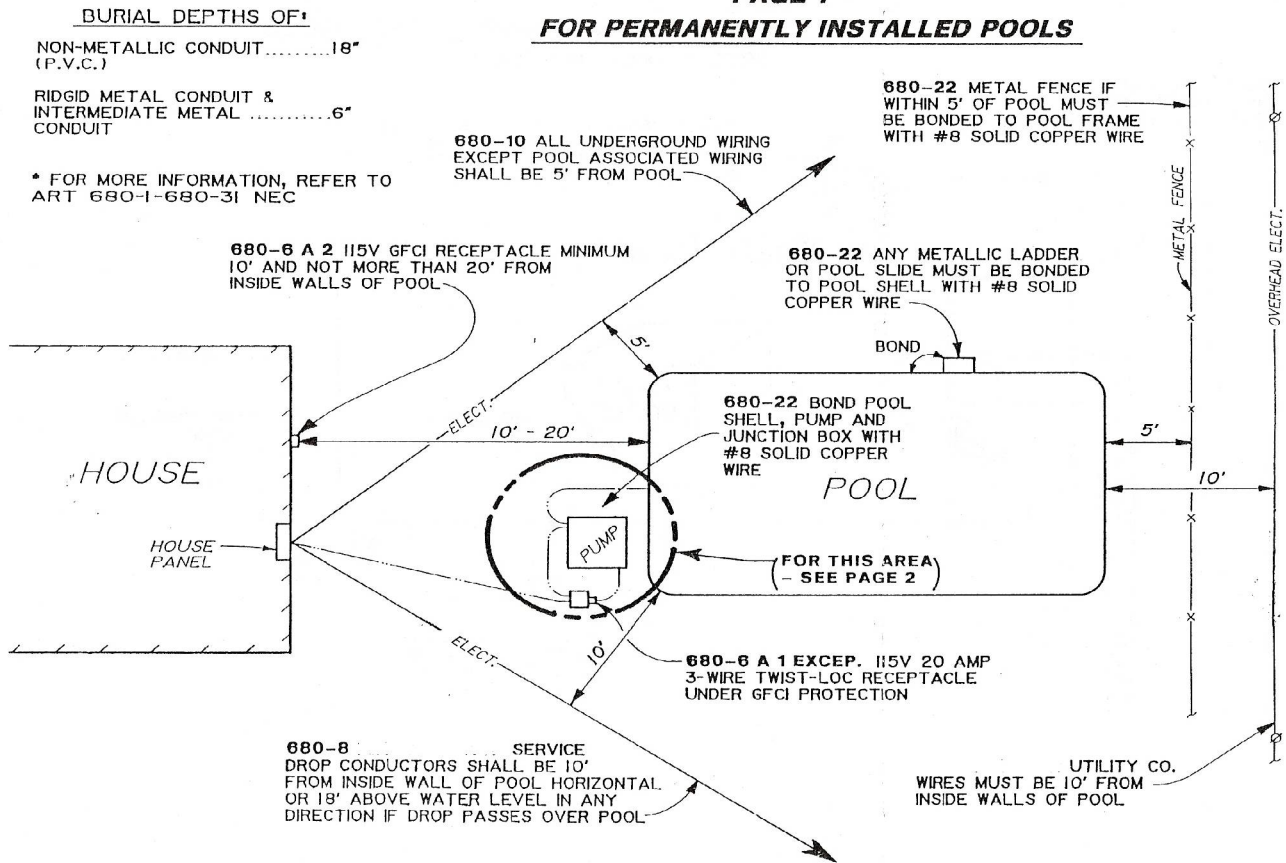

Electrical Permit fee schedule – Sample for bonding of pool only If a circuit is needed for pool equipment add 1 circuit @ \$5 each.

VIII. Fee Chart - Enter the number of items being installed, multiply by the unit price for total fee.

	FEE	# ITEMS	TOTAL
1. Application Fee (non-refundable)	\$50.00	1	\$50.00
Service			
2. Through 200 Amp.	\$10.00		
3. Over 200 Amp. thru 600 Amp.	\$15.00		
4. Over 600 Amp. thru 800 Amp.	\$20.00		
5. Over 800 Amp. thru 1200 Amp.	\$25.00		
6. Over 1200 Amp. (GFI only)	\$50.00		
7. Circuits	\$5.00		
8. Lighting Fixtures - per 25	\$6.00		
9. Dishwasher	\$5.00		
10. Furnace - Unit Heater	\$5.00		
11. Electrical Heating Units (baseboard)	\$4.00		
12. Power Outlets (ranges, dryers, etc.)	\$7.00		
Signs			
13. Unit	\$10.00		
14. Letter	\$15.00		
15. Neon - each 25 feet	\$20.00		
16. Feeders-Bus Ducts, etc. - per 50'	\$6.00		
17. Mobile Home Park Site*	\$6.00		
18. Recreational Vehicle Park Site	\$4.00		

	FEE	# ITEMS	TOTAL
K.V.A. & H.P.			
19. Units up to 20	\$8.00		
20. Units 21 to 50 K.V.A. or H.P.	\$10.00		
21. Units 51 K.V.A. or H.P. & over	\$12.00		
Fire Alarm Systems			
22. Up to 10 devices	\$50.00		
23. 11 to 20 devices	\$100.00		
24. Over 20 devices	\$5.00 each		
Data / Telecommunication Outlets			
31. Up to 10 devices	\$50.00		
32. 11 to 20 devices	\$100.00		
33. Over 20 devices	\$5.00 each		
25. Energy Retrofit - Temp. Control			
26. Conduit only or grounding only	\$45.00		
Inspections			
27. Special/Safety Insp. (includes cert. fee)	\$50.00		
28. Additional Inspection	\$50.00		
29. Final Inspection	\$50.00	1	\$50.00
30. Certification Fee	\$20.00		

Total Fee (Must include the \$50.00 non-refundable application fee) **\$100.00**

* See VII. Fee Classification Item #17 above

PAGE 2

DETAIL FOR PERMANENTLY INSTALLED POOLS (CIRCLED AREA ON PAGE 1)

